

FACT SHEET

Location

Widely regarded as Australia's Galapagos and home to abundant native wildlife and spectacular natural beauty, Kangaroo Island sits a mere 15km from the shores of mainland South Australia. As Australia's third largest, the Island is 155km long by 55km wide and covers some 4,500 sq km.

With 21 National and Conservation parks, Kangaroo Island has established itself as a premiere destination for nature lovers of all types. The Island's prolific wildlife includes kangaroos, koalas, seals and sea lions, echidnas and a variety of birdlife, all revelling in this "zoo without fences".

Climate

A destination for all seasons, Kangaroo Island's climate is as dynamic as the scenery – from season to season the Island yields fresh perspectives. The Mediterranean climate produces warm summers and temperate winters. Daytime temperatures range from 25-35°C in summer to 14-18°C in winter.

Accommodation

Perched on a dramatic cliff top above the wild Southern Ocean, the Lodge comprises 21 luxe suites, each with breathtaking coastal panoramas. Featuring an environmentally sensitive design, the spacious suites embody the highest level of design integrity. Every consideration has been given to navigating the fine balance between nature, comfort and contemporary style.

All suites feature lavish king beds, sunken lounge, dramatic glass walled bathroom and outdoor terrace with occasional seating and daybed. Other features include walk-in robe, complimentary room bar, optional climate control, heated floors, wireless internet, music system, premium amenities, safe and telephone. Bathrobes, slippers, hairdryer and backpacks are provided along with twice daily housekeeping and signature evening turndown service.



Flinders Suite (11) 65m²

Features spacious interiors, king or twin beds, curved sunken lounge and outdoor terrace with day bed to take advantage of dramatic coastal views.

Capacity: 2 adults in existing bedding / max capacity 2 persons

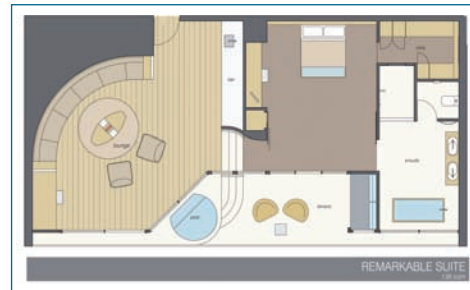

Remarkable Suite (2) 120m²

Features a king bedroom, separate lounge area with open fire, premium entertainment system, LCD TV and DVD player, spacious ensuite with handmade

timber bath tub and expansive outdoor terrace with day lounge and spa bath.

Capacity: 2 adults in existing bedding / max capacity 3 persons with rollaway



Ocean Retreat (5) 75m²

Generously spacious, Ocean Retreats offer king bedding, lounge with feature fireplace, ensuite with freestanding tub and terrace with day bed.

Capacity: 2 adults in existing bedding / max capacity 3 persons with rollaway

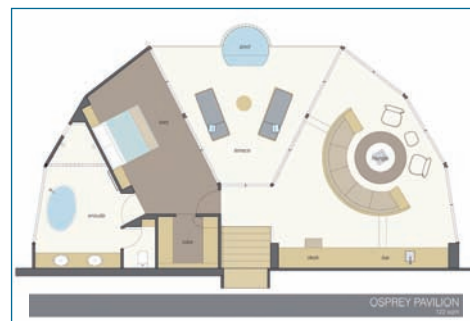

Osprey Pavilion (1) in excess of 120m²

The premium Osprey Pavilion is truly special with soul stirring ocean, beach and wilderness views. A unique curved floor plan features a sunken lounge

with open fire and state-of-the-art audio visual system, laptop computer, separate king bedroom, bathroom with hand sculptured bath and spacious outdoor terrace with daybeds and private plunge spa.

Capacity: 2 adults in existing bedding / max capacity 3 persons with rollaway



Ocean Family Suite (2) 120m²

Family suites feature an additional bedroom and bathroom and offer a separate living area with LCD TV and DVD player.

Capacity: 4 adults

OR 2 adults + 2 children in existing bedding / max capacity 5 persons with rollaway. Minimum occupancy of 3 persons (eg 2 adults + 1 child)

Check in/out Times

Check in 2pm / Check out 10.30am

Restaurant & Bar

A spectacular sweeping panorama of Hanson Bay provides a dramatic backdrop for savouring contemporary Australian cuisine, showcasing the freshest island and local seasonal produce. A convivial open bar and walk-in cellar highlight premium South Australian wines and beers whilst elegant interiors and personal service ensure a memorable dining experience. *Rates include full gourmet breakfast, light lunch, 4-course dinner with inspired daily menu and all beverages (cellarmasters list additional).*

The Great Room

The design pinnacle of the Lodge, the Great Room features floor to ceiling glass windows with full frontal panoramas and a sumptuous array of lounge choices. Outdoor seating areas and a heated wet-edge plunge pool invite total immersion in the pristine surroundings.

Baudin Lounge

A serene and private place to escape, read a book, watch a movie, enjoy a nature presentation or challenge a friend to a board game! Featuring a comprehensive reference library, interpretive display, movie and game library, the lounge can also be used for intimate meetings and events.

Capacity: 20 boardroom / 40 theatre style

Experiences & Adventures

Southern Ocean Lodge offers guests a complete Kangaroo Island experience. With selected guided island experiences included in the tariff, all guests enjoy a personalised experiential touring itinerary of the Island's unique natural attractions. A range of signature activities are offered daily allowing guests to encounter rich and varied wildlife, indulge in world-class food and wine and discover the Island's unique natural attractions, often with exclusive access and always with a touch of luxe. *Rates include Signature Lodge Experiences.* A menu of Bespoke Experiences provides further opportunity for exploration and excellent private charters are also available at additional cost.

Southern Spa

Housed in its own stunning pavilion, the Southern Spa is an intimate and private oasis of calm set amongst coastal drama. A signature spa menu offers a range of Li'tya rejuvenation and relaxation treatments, inspired by the Aboriginal dreamtime. Three treatment rooms, a steam room and chill lounge offer the ultimate pampering experience.

Services

Reception and boutique, business lounge, wireless internet, DVD, CD and reference library, daily laundry service (no dry cleaning) and postal service. Mobile/cell reception is limited on Kangaroo Island. All major credit cards are accepted at the Lodge.

Access

Located at Hanson Bay on the Island's south-west coast, the Lodge is a 50 or 90 minute drive from the airport or ferry terminal respectively. [Air Regional Express](#) (Rex) provide regular daily flights (30 mins) from Adelaide (ADL) to Kangaroo Island – Kingscote (KGC). A 15kg luggage limit per person applies; any excess may be uplifted or stored at Adelaide Airport for a nominal fee. [Charter Flights](#) Private charter flights are available from Adelaide to Kingscote or Snug Cove an exclusive private airfield just 30 minutes drive from the lodge. [Ferry SeaLink](#) operate regular 45 minute ferry transfers between Cape Jervis on the mainland and Penneshaw on Kangaroo Island. Cape Jervis is a picturesque two hour drive from Adelaide. [Car Hire](#) Whilst island experiences are included in the tariff, hiring a car can be fun and allows guests to explore Kangaroo Island as they like. Many mainland car hire companies have restrictions regarding their vehicles being driven on Kangaroo Island, and/or boarding the ferry. It's best to check terms with the operator. A good option is to hire a car on the island; [Budget](#) and [Hertz](#) operate both at Kingscote Airport and from the ferry terminal at Penneshaw. For more detailed information view the [Getting There & Away fact sheet](#).

Transfers

The Lodge operates transfers with fellow guests connecting with scheduled flights included in the tariff. Private transfers are available at additional cost and are required for connections with charter flights. Pre or post private touring is also an excellent transfer option.

Children

Southern Ocean Lodge welcomes children six years and over.

What to Bring

Dress is smart casual at Southern Ocean Lodge. Comfortable walking shoes, spray jacket and a warm top are recommended year-round, with additional warm clothing options suggested for the cooler months. Hat, camera, sunscreen and a keen sense of adventure are a must!

Luxury Lodges of Australia

Southern Ocean Lodge is honoured as a founding member of [Luxury Lodges of Australia](#), celebrating a new era of Australian experiential luxury accommodation and adventure.

Lodge Contacts

Southern Ocean Lodge

Hanson Bay, Kangaroo Island SA 5223

T 61 8 8559 7347

F 61 8 8559 7350

E reception@southernoceanlodge.com.au

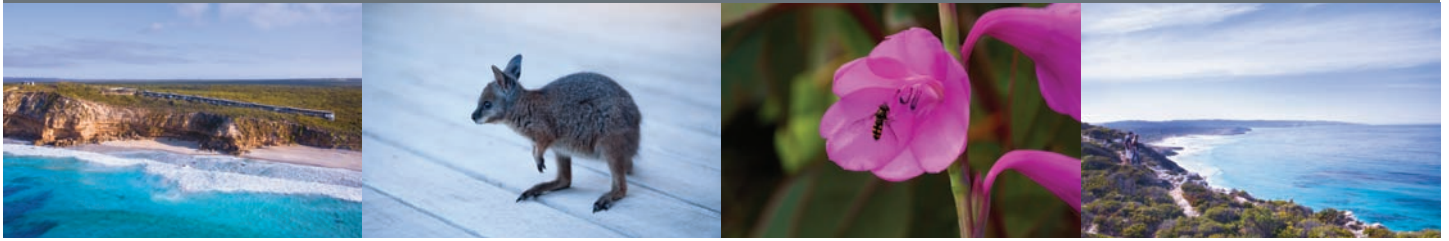

EXPERIENCES & ADVENTURES FACT SHEET

Widely regarded as Australia's Galapagos and brimming with diverse wildlife and natural beauty, Kangaroo Island is a place of extraordinary contrasts. With a rich heritage and a world-class food and wine culture, Australia's third largest island offers endless opportunities for exploration and adventure. Southern Ocean Lodge delivers guests a complete Kangaroo Island experience in a minimum two night stay. With selected guided island experiences included in the tariff, all guests enjoy a personalised experiential itinerary of the Island's unique natural attractions.

The Lodge activity program allows guests to experience Kangaroo Island in a stylish and relaxed manner. Southern Ocean Lodge is located at the heart of the Island's major natural attractions, bordered by two National Parks. To ensure an intimate and personal experience, excursions operate with usually no more than ten guests per group, in custom vehicles with private naturalist guides. Expeditions are scheduled during off-peak times so guests enjoy an exclusive safari feel to their guided encounters.

A Destination for All Seasons

Kangaroo Island's temperate climate yields new life year round and spectacular landscape changes in each season. The warm island summer is a time of rebirth; golden pastures and enchanting wildflowers provide a nursery backdrop for the newly born young of koalas, wallabies, kangaroos, fur seals and sea lions. Kangaroo Island comes into its own during the cool season with flourishing countryside and flowing rivers encouraging wildlife to venture out by day. Daytime temperatures range from 25-35°C in summer to 14-18°C in winter.

Typical 3 Night Experiences Program (KI Classic) Recommended minimum stay to enjoy both wonders – the Island and the Lodge!

Day 1	Day 2	Day 3	Day 4
<i>am</i> Arrive SOL	Breakfast	Breakfast	Breakfast
Signature welcome	<i>9am</i> Wonders of KI	<i>9am</i> Guided Adventure Hike* or Spa Treatment*	<i>am</i> Depart SOL for onward travel
<i>12.30pm</i> Lunch	<i>12.30pm</i> Return to SOL for Lunch	<i>12.30pm</i> Return to SOL for lunch	<i>Or</i> Private Departure Experience*
<i>2.30pm</i> Coastal Clifftop Walk	<i>2.30pm</i> Optional Bespoke Experience* or Spa Treatment*	<i>2pm</i> Seal Bay	<i>Or</i> Optional Bespoke Experience*
<i>4pm</i> Discover Island Heritage	<i>4.30pm</i> Return to SOL	<i>5pm</i> Return to SOL	<i>12.30pm</i> Lunch
<i>6pm</i> Pre Dinner Drinks & Canapés	<i>6pm</i> Pre Dinner Drinks & Canapés	<i>5.30pm</i> Kangas & Kanapés	Enjoy the Southern Spa*
<i>7pm</i> Dinner at leisure	<i>7pm</i> Dinner at leisure	<i>7pm</i> Dinner at leisure	<i>pm</i> Depart SOL

*Additional charges apply

Times may vary slightly with the seasons

Signature Lodge Experiences (Included)

These experiences are provided on an intimate shared basis with fellow guests at scheduled times. Private touring can be arranged at additional cost subject to availability.

Wonders of KI

This half day experience, operated exclusively for Lodge guests by Exceptional Kangaroo Island is a spectacular introduction to Kangaroo Island's wildlife, maritime heritage and stunning coastal landscapes and takes full advantage of the Lodge's unique location. Cape du Couedic Lighthouse, Remarkable Rocks, Admirals Arch and a fur seal colony are just some of the trip highlights. Wander amongst the rare Cape Barren Geese and search the leafy eucalypts for a sleepy koala.

Seal Bay

Seal Bay is home to Australia's third largest colony of Australian sea lions. Join our naturalist guide for an exclusive tour on the beach with these wild animals. Learn about their unique breeding cycle and the ongoing research programs implemented on site. After your up close and personal experience relax with morning tea at the picturesque Vivonne Bay.

Coastal Clifftop Walk

Take a scenic walk starting right on the Lodge's doorstep atop the limestone cliffs of Hanson Bay. This easy walk affords a bird's eye view of thundering waves crashing along the coastline. Stand on top of the cliff with the wind blowing, look out to sea and realise there is nothing but ocean between here and Antarctica. Experience and learn about local flora, fauna and coastline ecosystems. *Tip: A photographer's dream!*

Kangas & Kanapés

Soak up the history of the early island settlers at Edward's Cottage, the historic Grassdale property reached by a short drive from the Lodge where local wildlife including kangaroos and wallabies congregate to graze. Observe these creatures in their natural environment, sip champagne and enjoy a 'Kanapé' whilst the sun goes down on another magical day.

Discover Island Heritage

Discover the intriguing natural heritage of this wild island in the Baudin Lounge. This informative visual presentation hosted by resident naturalist staff provides insight into the Island's discovery and natural history and gives an overview of its many spectacular attractions. Refresh with a sunset drink at the convivial Lodge Bar.

Included experiences may be enjoyed on a private basis for an additional fee, subject to availability.



Bespoke Experiences *(Additional Charges Apply)*

An additional menu of bespoke KI experiences offers the chance to tailor a special interest itinerary. Activities operate on a limited share basis for an exclusive safari feel.

Adventure

Quad Bike Safari

Departing from the Lodge, this fun, interpretive quad bike adventure tour heads into the neighbouring natural bushland at Hanson Bay Sanctuary. 'In-helmet' commentary is provided by a Southern Ocean Lodge naturalist guide leading the expedition, providing an insight to the local wildlife and landscape seen along the way. The Sanctuary is home to kangaroos, koalas, possums, wallabies, echidnas, goannas and birdlife in abundance, so bring a camera and sense of adventure. This adventure is available to guests 16 years and over.

Kayak Adventure

Take a kayak from the Lodge and glide with a guide along the calm and meandering waters on the South West River, beginning at nearby Hanson Bay. Enjoy the scenery and a variety of birdlife, flora and fauna that inhabit this diverse ecosystem.

Beach Fishing

Beachcombe to a nearby secluded beach, reel and tackle in hand. Wet your line and enjoy some peaceful solitude whilst dolphins crest the waves in welcome. Return to the lodge where the chef will transform your catch into an epicurean delight for lunch or dinner. The beaches and coves are also a great spot for an early morning or afternoon walk.

Nocturnal Tour

A visit to the Hanson Bay Sanctuary to discover a world that comes alive while you are asleep. Spot the local koalas, meet hand reared kangaroos and wallabies and see echidnas, bats and possums. A fun and educational discovery walk.

Guided Adventure Hikes

Each morning there is a scheduled hike. Options include:

Explore Cape Younghusband

Take an awe inspiring journey of exploration along the edge of the cliff tops to Cape Younghusband. Experience the wonder of sheer limestone cliffs and hardy flora growing along this rugged coastline, spot the Osprey hovering above, the fur seals frolicking in the Southern Ocean waters below and the intriguing formations of the Remarkable Rocks in the distance.

Kelly Hill to Hanson Bay

Explore the back country of the Kelly Hill Conservation Park through the Grassdale property and onto Hanson Bay Beach. A fascinating variety of vegetation types from Eucalypt woodlands through Mallee and coastal heath. Views over Grassdale lagoons also provide the opportunity for sighting water birds and the meandering trail hosts a number of terrestrial orchids and wildflowers.

West Bay Blowhole Trek

For the avid bushwalker, this trek is one of both dramatic scenic beauty and fascinating local history. The journey starts with an interesting drive from the lodge to West Bay through dense bushland and open plains where local wildlife including kangaroos and Tamar wallabies graze. The western island coastline is simply spectacular, refreshing for the soul! A memorable experience on this journey is discovering the Loch Vennachar shipwreck and its story.

Platypus Waterholes

Commencing at the Flinders Chase Visitors Centre and allowing time to enjoy bird life and the serenity of the surrounding landscape at a relaxed pace. The trail weaves through areas featuring diverse plant species and the opportunity to spot the intriguing platypus. These unique aquatic mammals, distinguished by a duck-like beak and webbed feet are very shy so to spot one is a special event.

Snake Lagoon Walk

Take an enchanting walk starting at the sinister-sounding Snake Lagoon and trek along a section of the Rocky River to its mouth at the Southern Ocean. This is a popular trail that winds through forests of Sugar Gums and Mallee before descending into the Rocky River Valley. The area's regeneration after devastating bushfires in 2007 is inspiring to see. The trail crosses Rocky River and meanders along its bank, offering an easy trek to the river's mouth and spectacular views through the valley and across the wild Southern Ocean.



Half Day Special Interest Tours

Southern Ocean Lodge offers a diverse range of private experiences from the epicurean to the artistic, water based or family fun.

Art Lovers

The untouched wilderness of Kangaroo Island provides inspiration for artists working across an amazing range of mediums. This half day tour follows a journey that takes in both the Rustic Blue and Kangaroo Fine Art Gallery. Learn the stories and see the works of renowned artists including Janine Mackintosh, ceramist Mark Capon and Indiana James with his incredible sculptures created from recycled and found objects.

Birds of Prey

The Raptor Domain near Seal Bay offers a hands-on, up close experience with some of Australia's most impressive birds of prey. Watch these magnificent birds in a free-flight demonstration and meet the well-trained stars of the show, Jedda the Wedge-tailed eagle and Banjo and Clancy, a pair of laughing kookaburras. *Tip: Tour can be combined with Private Seal Bay.*

Epicurean Adventure

Perfect for those with a keen interest in food and wine, and its journey from paddock to plate: a short one at Southern Ocean Lodge! This half day tour takes in some of Kangaroo Island's finest producers, whose products are each showcased on the menu; sample wines at Two Wheeler Creek Vineyard, choose freshwater crayfish at the Andermel Marron Farm, see the sheep milking and taste heavenly haloumi at Island Pure Sheep Dairy and meet the Ligurian bees and their precious honey at Island Beehive.

Heart of Flinders Chase

This half day tour further explores the 34,000 hectare wilderness of Flinders Chase National Park, and is an ideal compliment to the KI Wonders Tour. A nine kilometre hike meanders through the various habitats along Rocky River to Platypus Waterholes. It's a chance to catch a glimpse of the elusive platypus, to listen for forest birds and look for wildflowers and delicate bush orchids.

Family Fun

Enjoy some good old-fashioned family fun with sand boards, fishing gear, kites and morning tea. This fun morning or afternoon activity heads to the heights of the white-sanded dunes at Little Sahara for thrill-seeking antics for all on sand boards and toboggans. Try for a fish and a catch-up on the jetty at nearby Vivonne Bay, and fly kites if the wind is right!

Marine Tour

In association with the excellent island marine adventure operators, KI Marine Adventures, this excursion offers the chance to get wet and wild and meet the Southern Ocean locals from a zodiac. Take in the Kangaroo Island coastline from a different perspective, encounter dolphins and a variety of seabirds including penguins, sea eagles, albatross and pelicans.

Private Charters with Language Guide

A variety of private itineraries are available with naturalist guides fluent in French, German or Italian. Other languages available on request (*charges apply*).

Additional Activities

Complimentary: Mountain bikes, walking trails and a DVD, book and board game library.

External Operators: For the more adventurous, deep sea fishing, scuba diving and helicopter scenic flights are also available (*charges apply*).



Exceptional Kangaroo Island (EKI)

A range of excellent private itineraries are available from renowned island operator Exceptional Kangaroo Island. Explore Australia's spectacular wildlife haven from the comfort of a customised four wheel drive, in the hands of enthusiastic guides promising good food, good wine and wildlife in the wild.

EKI Full Day Private Charters

*Charges Apply**

Kangaroo Island Icons: A full day tour exploring the Island's key landscape and wildlife icons includes Remarkable Rocks, the coastal grotto of Admirals Arch, home to a fur seal colony and the loveable sea lions at Seal Bay. This private safari includes a delicious lunch at an idyllic bush setting.

Exclusively Flinders Chase: Flinders Chase National Park is a vast wilderness covering the entire west end of the island. Visit a fur seal colony, Cape du Couedic Lighthouse, Remarkable Rocks, Admirals Arch and the endless bush which provides habitat for a host of Australian wildlife including kangaroos, wallabies, possums, goannas, echidnas, koalas and platypus.

North West Wilderness: A historical trip taking in some original tracks used by early settlers to access lighthouses and haul supplies from sailing vessels. Visit Cape Borda Lighthouse Station, Scotts Cove (the second highest cliffs in Australia) and Western River Cove. Take up some more challenging hiking if desired.

Epicurean Adventure: A full day tour to the Island's best produce farms. This tour encompasses wineries, a sheep dairy and seafood farms – experience the journey of produce to plate.

Art of Nature: The nature and beauty of Kangaroo Island attracts and inspires creativity. Take a journey through a selection of the Island's studios, galleries and workshops and on occasion meet the artists.

*Full Day Private Charters include morning/afternoon tea and gourmet lunch in the wild including beverages. *Included when booked as part of KI Dreaming package.*

EKI Welcome and Departure Experiences

Charges Apply includes one way airport transfer*

Southern Ocean Welcome: A wonderful opportunity to become acquainted with Kangaroo Island via a journey through the centre of the island and along the South Coast – Kohinoor Range, Seal Bay Conservation Park, Little Sahara, Vivonne Bay. Receive an introduction to the landscape, the wildlife habitat and the local lifestyle before arriving at the Lodge.

North Coast Departure: Get your final fix of Kangaroo Island by experiencing the protected North coast – large headlands bracketing sweeping beaches and hills rolling down to Investigator Strait make for spectacular coastal vistas. Explore sheltered coves, protected valleys and open farmland. This tour ends at the Airport in time to connect with departure flights.

*Welcome and Departure Experiences include morning/afternoon tea and gourmet lunch in the wild including beverages. *Included when booked as part of KI Dreaming package.*

EKI Private Touring Additional Activities

Charges Apply

Island Adventure

The following options are available combined with one of the Full Day Private Charters above.

Kangaroo Island Marine Tour: Explore KI's coast and marine environment while ocean rafting and swimming with wild dolphins. All equipment provided, subject to weather conditions.

KI Outdoor Action Quad Biking: Jump on a quad bike and explore private bushland tracks down to the coast at Vivonne Bay for an adrenalin pumping adventure!

A Day in the Life of a Wildlife Researcher: Join Peggy Rismiller a world expert on echidnas for an hour or two over lunch in the bush and chat about her intriguing career researching this amazing Australian mammal.

Tory M Fishing Charters: Take to the seas on a half or full day fishing charter in the tranquil waters surrounding American River, abundant in King George Whiting, Garfish, Salmon and Snook amongst others.

Kangaroo Island After Dark

Bright Lights on Arrival: Be greeted by your guide on arrival at Kingscote Airport before enjoying dinner at Restaurant Bella in Kingscote. Visit the penguins resting ashore after a big day out and learn how they have adapted to life in town. A drive through farm paddocks enroute to the Lodge gives a great feel for the abundance of native animals on the island.

Quad Biking and Bush Picnic: Take a short drive from the Lodge to a private farm for a dusk quad bike tour and truly get off the beaten track! Enjoy picnic dinner in the bush before seeking out a wild colony of little penguins and spot the Island's nocturnal animals on the return trip.

Out on the Town: Commencing from the Lodge, be driven by your guide to the town centre and enjoy dinner at Restaurant Bella in Kingscote. Meet the penguins and view their nest burrows before making your way back to the Lodge via farm paddocks encountering the local wildlife along the way.

Bush Barbeque: Depart the Lodge and take a short trip to a private bush venue for a barbeque dinner, complete with wallabies and kangaroos grazing nearby. Spot a wild colony of penguins and marvel at these little creatures of the sea. A drive through farm paddocks once dark allows complete immersion in the active KI nightlife!